

**PETITION TO THE CITY COUNCIL OF THE CITY OF MENIFEE
REQUESTING ANNEXING TERRITORY INTO COMMUNITY
FACILITIES DISTRICT NO. 2017-1 (MAINTENANCE SERVICES) OF
PROPERTY WITHIN THE CITY OF MENIFEE AND A WAIVER WITH
RESPECTS TO CERTAIN PROCEDURAL MATTERS UNDER THE
MELLO-ROOS COMMUNITY FACILITIES ACT OF 1982 AND
CONSENTING TO THE LEVY OF SPECIAL TAXES THEREON TO PAY
THE COSTS OF SERVICES TO BE PROVIDED BY THE COMMUNITY
FACILITIES DISTRICT**

1. The undersigned requests that the City Council of the City of Menifee, initiate and conduct proceedings pursuant to the Mello-Roos Community Facilities Act of 1982 (the "Act") (Government Code Section 53311 et seq.), to annex territory into Community Facilities District No. 2017-1 (Maintenance Services) of the property described below and consents to the annual levy of special taxes on such property to pay the costs of services to be provided by the Community Facilities District.

2. The undersigned requests that the community facilities district provide any services that are permitted under the Act including, but not limited to, all necessary service, operations, administration and maintenance required to keep the landscape lighting, street lighting, flood control facilities, ground cover, shrubs, plants and trees, irrigation systems, graffiti removal, sidewalks and masonry walls, fencing entry monuments, tot lot equipment and associated appurtenant facilities within the district in a healthy, vigorous and satisfactory working condition.

3. The undersigned hereby certifies that as of the date indicated opposite its signature, it is the owner of all the property within the proposed boundaries of the Community Facilities District described in Exhibit A hereto and as shown on the map Exhibit B hereto.

4. The undersigned requests that a special election be held under the Act to authorize the special taxes for the proposed annexation into Community Facilities District No. 2017-1. The undersigned waives any requirement for the mailing of the ballot for the special election and expressly agrees that said election may be conducted by mailed or hand-delivered ballot to be returned as quickly as possible to the designated election official, being the office of the City Clerk and the undersigned request that the results of said election be canvassed and reported to the City Council at the same meeting of the City Council as the public hearing on annexing territory into Community Facilities District No. 2017-1 or at the next available meeting.

5. Pursuant to Sections 53326(a) and 53327(b) of the Act, the undersigned expressly waives all applicable waiting periods for the election and waives the requirement for analysis and arguments relating to the special election, and consents to not having such materials provided to the landowner in the ballot packet, and expressly waives any requirements as to the form of the ballot. The undersigned expressly waives all notice requirements relating to hearings and special elections (except for published notices required by the Act), and whether such requirements are found in the California Elections Code, the California Government Code or other laws or procedures, including but not limited to any notice provided for by compliance with the provisions of Section 4101 of the California Elections Code.

6. The undersigned hereby consents to and expressly waives any and all claims based on any irregularity, error, mistake or departure from the provisions of the Act or other laws of the State and any and all laws and requirements incorporated therein, and no step or action in any proceeding relative to annexing territory into Community Facilities District No. 2017-1 of the portion of the incorporated area of

the City of Menifee or the special election therein shall be invalidated or affected by any such irregularity, error, mistake or departure.

IN WITNESS WHEREOF, I hereunto set my hand this 10th day of May, 2024.

PULTE HOME COMPANY, LLC
a Michigan limited liability company

By: 

Name: Darren Warren

Title: Vice President Land Acquisitions &
Development

OWNER'S PROPERTY:

Tract Map No. 37671-1, 37671-2, 37671-F
(Formerly, Tract No. 32101)

OWNER'S MAILING ADDRESS:

27401 Los Altos, Ste. 400
Mission Viejo, CA 92691

FILED IN THE OFFICE OF THE CITY CLERK OF THE CITY COUNCIL OF THE CITY OF
MENIFEE THIS ____ DAY OF _____, 2024.

City Clerk of the City Council of the
City of Menifee

EXHIBIT A: LEGAL DESCRIPTION

Real property in the City of Menifee, County of Riverside, State of California, described as follows:

PARCEL I OF PARCEL MAP 38627, IN THE CITY OF MENIFEE, COUNTY OF RIVERSIDE, STATE OF CALIFORNIA, AS PER MAP RECORDED IN BOOK 257, PAGES 98 THROUGH 102, INCLUSIVE, OF PARCEL MAPS, RECORDED AS DOCUMENT NO. 2024-0058006 ON MARCH 1, 2024 IN THE OFFICE OF THE COUNTY RECORDER OF SAID COUNTY.

TENTATIVE TRACT MAP NO. 37671
CITY OF MENIFEE

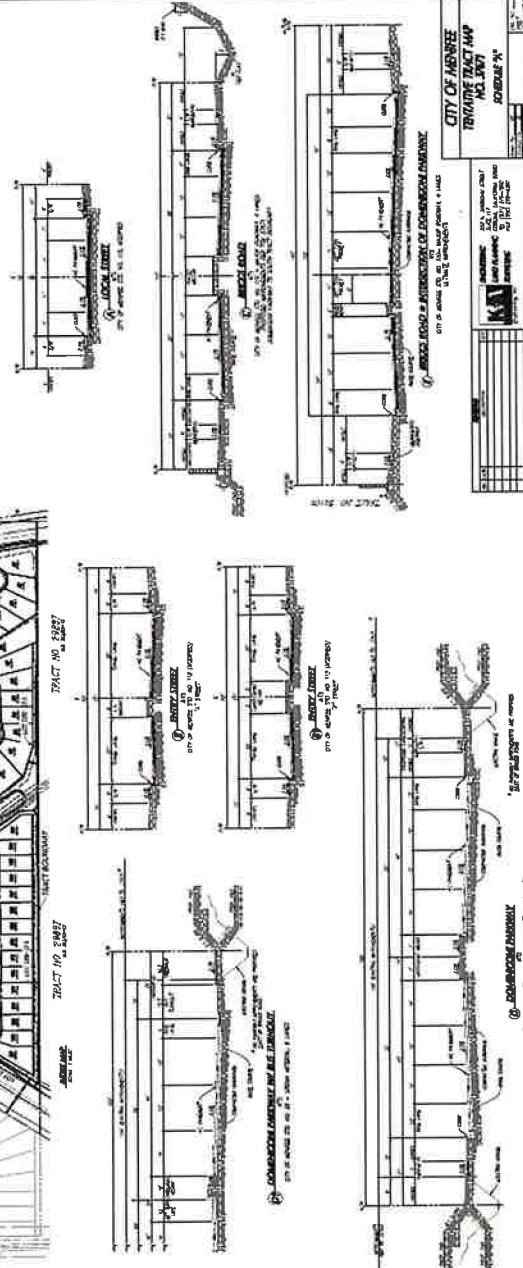
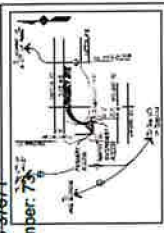
[illegible][illegible]

12-1	12-2	12-3	12-4	12-5	12-6	12-7	12-8	12-9	12-10	12-11	12-12	12-13	12-14	12-15	12-16	12-17	12-18	12-19	12-20	12-21	12-22	12-23	12-24	12-25	12-26	12-27	12-28	12-29	12-30	12-31	12-32	12-33	12-34	12-35	12-36	12-37	12-38	12-39	12-40	12-41	12-42	12-43	12-44	12-45	12-46	12-47	12-48	12-49	12-50	12-51	12-52	12-53	12-54	12-55	12-56	12-57	12-58	12-59	12-60	12-61	12-62	12-63	12-64	12-65	12-66	12-67	12-68	12-69	12-70	12-71	12-72	12-73	12-74	12-75	12-76	12-77	12-78	12-79	12-80	12-81	12-82	12-83	12-84	12-85	12-86	12-87	12-88	12-89	12-90	12-91	12-92	12-93	12-94	12-95	12-96	12-97	12-98	12-99	12-100	12-101	12-102	12-103	12-104	12-105	12-106	12-107	12-108	12-109	12-110	12-111	12-112	12-113	12-114	12-115	12-116	12-117	12-118	12-119	12-120	12-121	12-122	12-123	12-124	12-125	12-126	12-127	12-128	12-129	12-130	12-131	12-132	12-133	12-134	12-135	12-136	12-137	12-138	12-139	12-140	12-141	12-142	12-143	12-144	12-145	12-146	12-147	12-148	12-149	12-150	12-151	12-152	12-153	12-154	12-155	12-156	12-157	12-158	12-159	12-160	12-161	12-162	12-163	12-164	12-165	12-166	12-167	12-168	12-169	12-170	12-171	12-172	12-173	12-174	12-175	12-176	12-177	12-178	12-179	12-180	12-181	12-182	12-183	12-184	12-185	12-186	12-187	12-188	12-189	12-190	12-191	12-192	12-193	12-194	12-195	12-196	12-197	12-198	12-199	12-200	12-201	12-202	12-203	12-204	12-205	12-206	12-207	12-208	12-209	12-210	12-211	12-212	12-213	12-214	12-215	12-216	12-217	12-218	12-219	12-220	12-221	12-222	12-223	12-224	12-225	12-226	12-227	12-228	12-229	12-230	12-231	12-232	12-233	12-234	12-235	12-236	12-237	12-238	12-239	12-240	12-241	12-242	12-243	12-244	12-245	12-246	12-247	12-248	12-249	12-250	12-251	12-252	12-253	12-254	12-255	12-256	12-257	12-258	12-259	12-260	12-261	12-262	12-263	12-264	12-265	12-266	12-267	12-268	12-269	12-270	12-271	12-272	12-273	12-274	12-275	12-276	12-277	12-278	12-279	12-280	12-281	12-282	12-283	12-284	12-285	12-286	12-287	12-288	12-289	12-290	12-291	12-292	12-293	12-294	12-295	12-296	12-297	12-298	12-299	12-300	12-301	12-302	12-303	12-304	12-305	12-306	12-307	12-308	12-309	12-310	12-311	12-312	12-313	12-314	12-315	12-316	12-317	12-318	12-319	12-320	12-321	12-322	12-323	12-324	12-325	12-326	12-327	12-328	12-329	12-330	12-331	12-332	12-333	12-334	12-335	12-336	12-337	12-338	12-339	12-340	12-341	12-342	12-343	12-344	12-345	12-346	12-347	12-348	12-349	12-35
------	------	------	------	------	------	------	------	------	-------	-------	-------	-------	-------	-------	-------	-------	-------	-------	-------	-------	-------	-------	-------	-------	-------	-------	-------	-------	-------	-------	-------	-------	-------	-------	-------	-------	-------	-------	-------	-------	-------	-------	-------	-------	-------	-------	-------	-------	-------	-------	-------	-------	-------	-------	-------	-------	-------	-------	-------	-------	-------	-------	-------	-------	-------	-------	-------	-------	-------	-------	-------	-------	-------	-------	-------	-------	-------	-------	-------	-------	-------	-------	-------	-------	-------	-------	-------	-------	-------	-------	-------	-------	-------	-------	-------	-------	-------	-------	--------	--------	--------	--------	--------	--------	--------	--------	--------	--------	--------	--------	--------	--------	--------	--------	--------	--------	--------	--------	--------	--------	--------	--------	--------	--------	--------	--------	--------	--------	--------	--------	--------	--------	--------	--------	--------	--------	--------	--------	--------	--------	--------	--------	--------	--------	--------	--------	--------	--------	--------	--------	--------	--------	--------	--------	--------	--------	--------	--------	--------	--------	--------	--------	--------	--------	--------	--------	--------	--------	--------	--------	--------	--------	--------	--------	--------	--------	--------	--------	--------	--------	--------	--------	--------	--------	--------	--------	--------	--------	--------	--------	--------	--------	--------	--------	--------	--------	--------	--------	--------	--------	--------	--------	--------	--------	--------	--------	--------	--------	--------	--------	--------	--------	--------	--------	--------	--------	--------	--------	--------	--------	--------	--------	--------	--------	--------	--------	--------	--------	--------	--------	--------	--------	--------	--------	--------	--------	--------	--------	--------	--------	--------	--------	--------	--------	--------	--------	--------	--------	--------	--------	--------	--------	--------	--------	--------	--------	--------	--------	--------	--------	--------	--------	--------	--------	--------	--------	--------	--------	--------	--------	--------	--------	--------	--------	--------	--------	--------	--------	--------	--------	--------	--------	--------	--------	--------	--------	--------	--------	--------	--------	--------	--------	--------	--------	--------	--------	--------	--------	--------	--------	--------	--------	--------	--------	--------	--------	--------	--------	--------	--------	--------	--------	--------	--------	--------	--------	--------	--------	--------	--------	--------	--------	--------	--------	--------	--------	--------	--------	--------	--------	--------	--------	--------	--------	--------	--------	--------	--------	--------	--------	--------	--------	--------	--------	--------	--------	--------	--------	-------