



# MENIFEE

New. Better. Best.

ENVIRONMENTAL GRAPHICS + WAYFINDING  
SITE SIGNAGE SCHEMATIC DESIGN

MARCH 09, 2023

rsmdesign





Conceptual Daytime Rendering



Conceptual Nighttime Rendering

**rsm**design

San Clemente, CA  
949.492.9479

Dallas, TX  
972.974.3690

Los Angeles, CA  
213.705.9006

rsmdesign.com

**PACKAGE NOTES**  
All drawings and written materials appearing herein constitute original and unpublished work of RSM Design Inc. and may not be used or disclosed without written consent of RSM Design Inc.

All drawings must comply with specifications noted in this document.

**PLEASE NOTE**  
All reference images are for internal use only. RSM Design does not have copyrights for said images and therefore should not be published or shared.

REVISIONS:	DATE:
1	
2	
3	
4	
5	

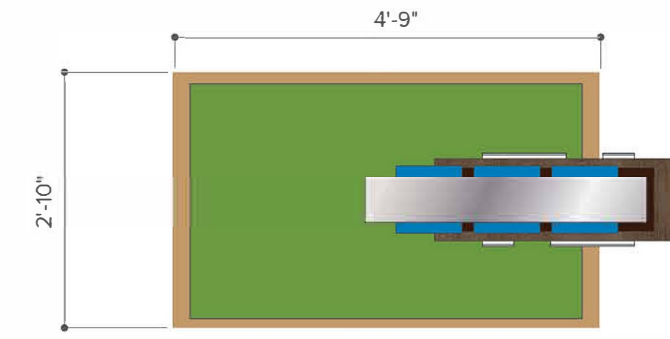

1 Top View  
Scale : 1/2"=1'

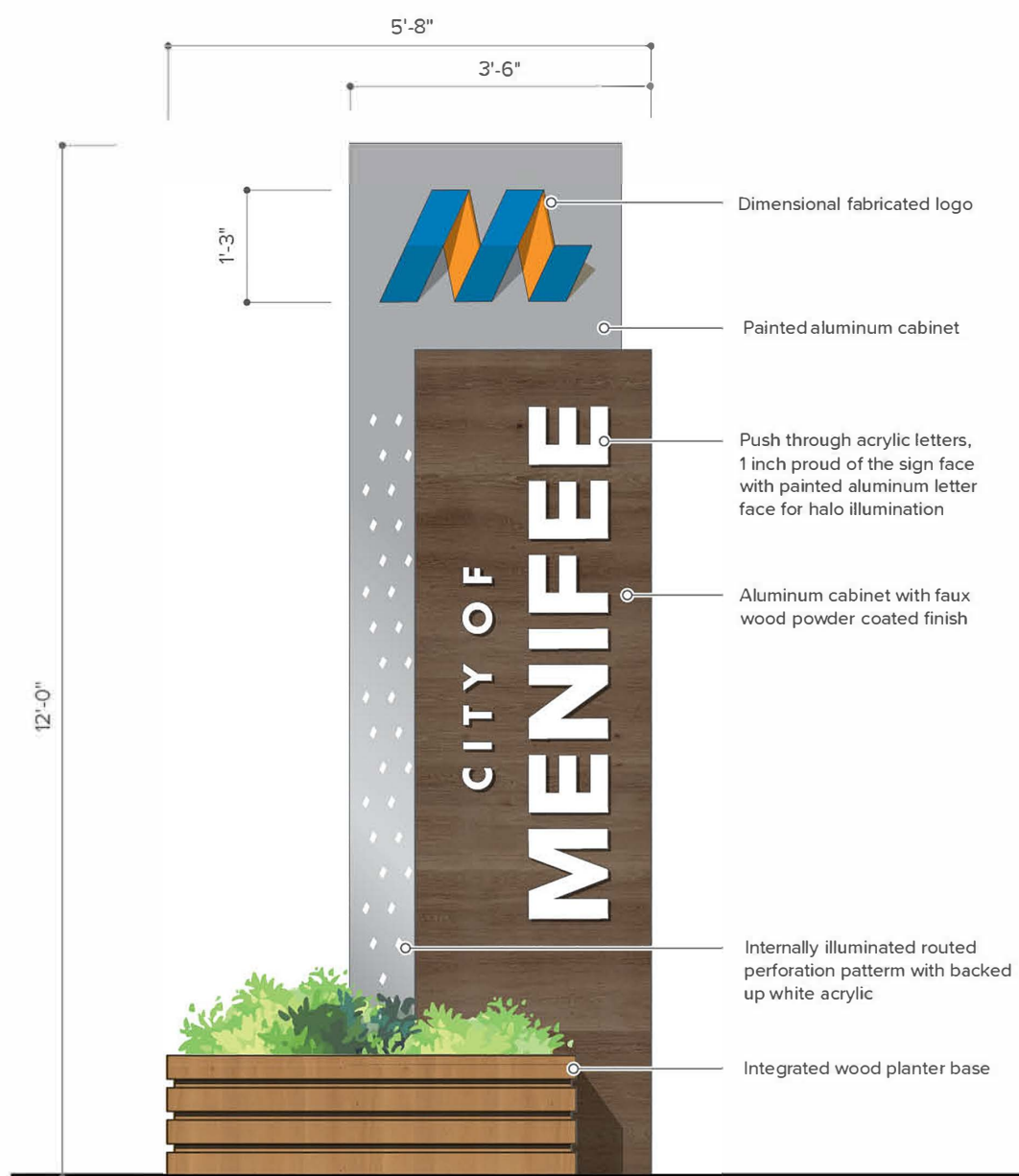

2 Front View\*  
Scale : 1/2"=1'  
\*similar to Back

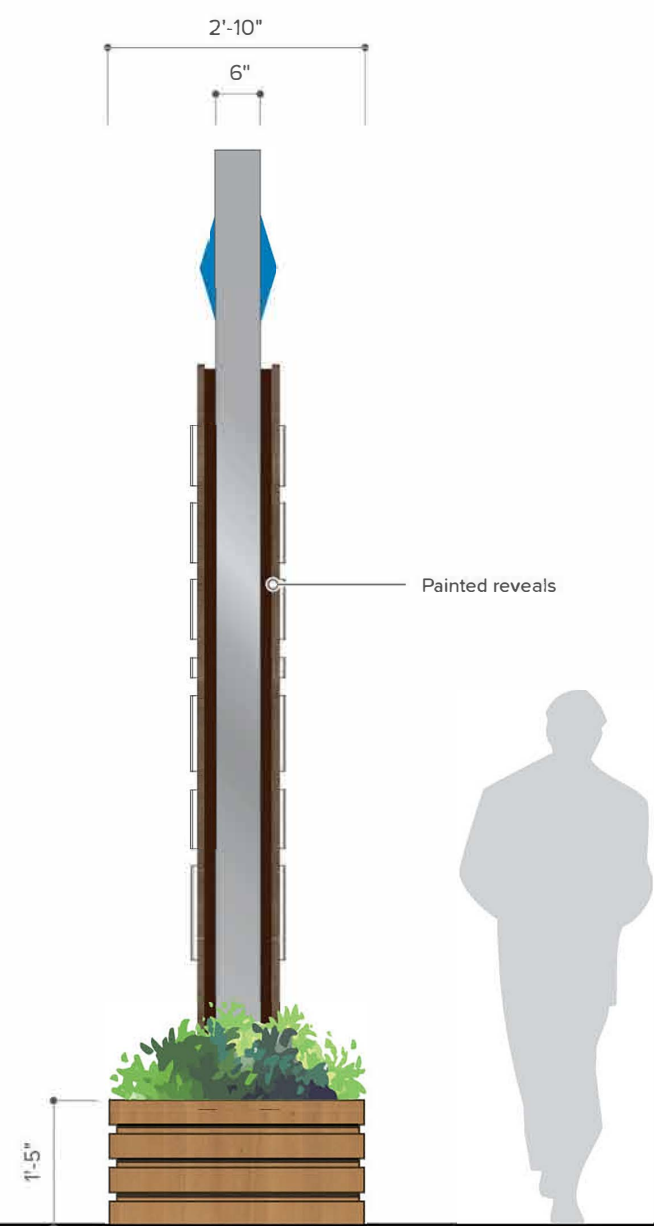

3 Side View  
Scale : 1/2"=1'

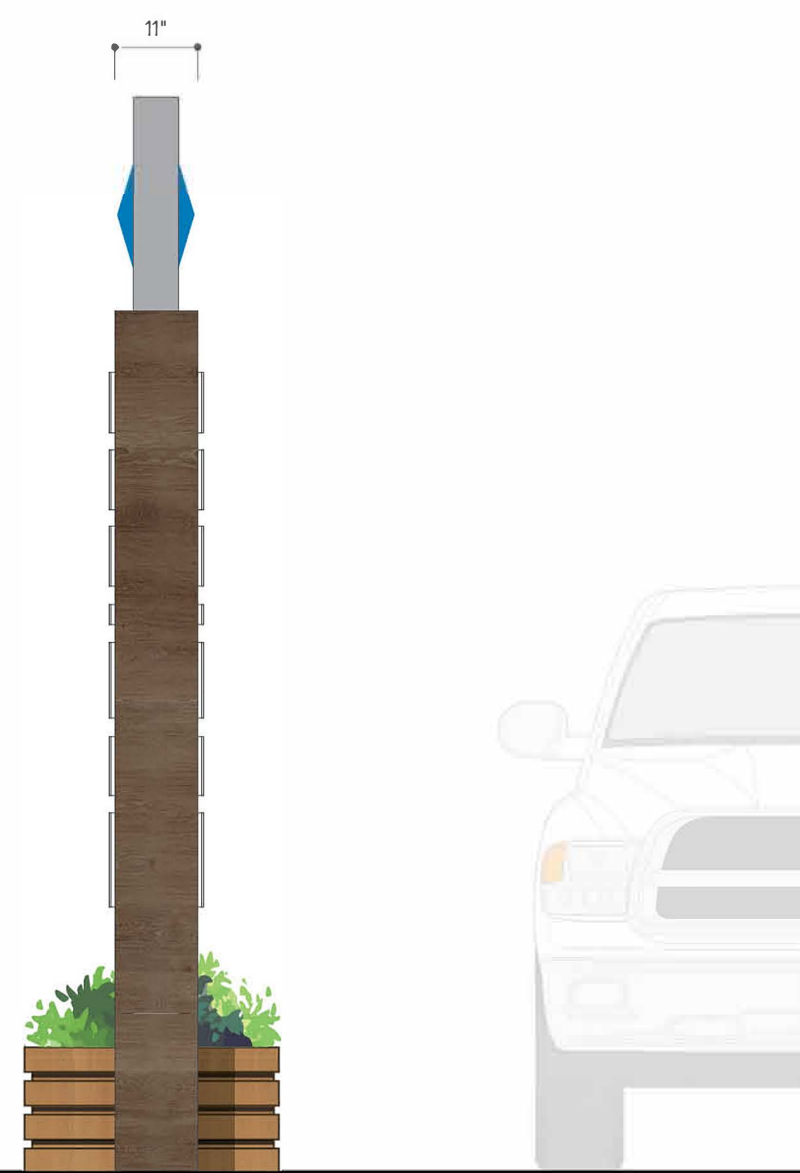

4 Side View  
Scale : 1/2"=1'

**PACKAGE NOTES**  
All drawings and written materials appearing herein constitute original and unpublished work of RSM Design Inc. and may not be used or disclosed without written consent of RSM Design Inc.

All drawings must comply with specifications noted in this document.

**PLEASE NOTE**  
All reference images are for internal use only. RSM Design does not have copyrights for said images and therefore should not be published or shared.

REVISIONS:      DATE:

1		1
2		2
3		3
4		4



PREVIOUS  
DESIGN

- DIFFICULT FABRICATION DETAILS
- OPEN SPACES COLLECT DUST AND DEBRIS
- LOGO IS OBSCURED BY SHADOW

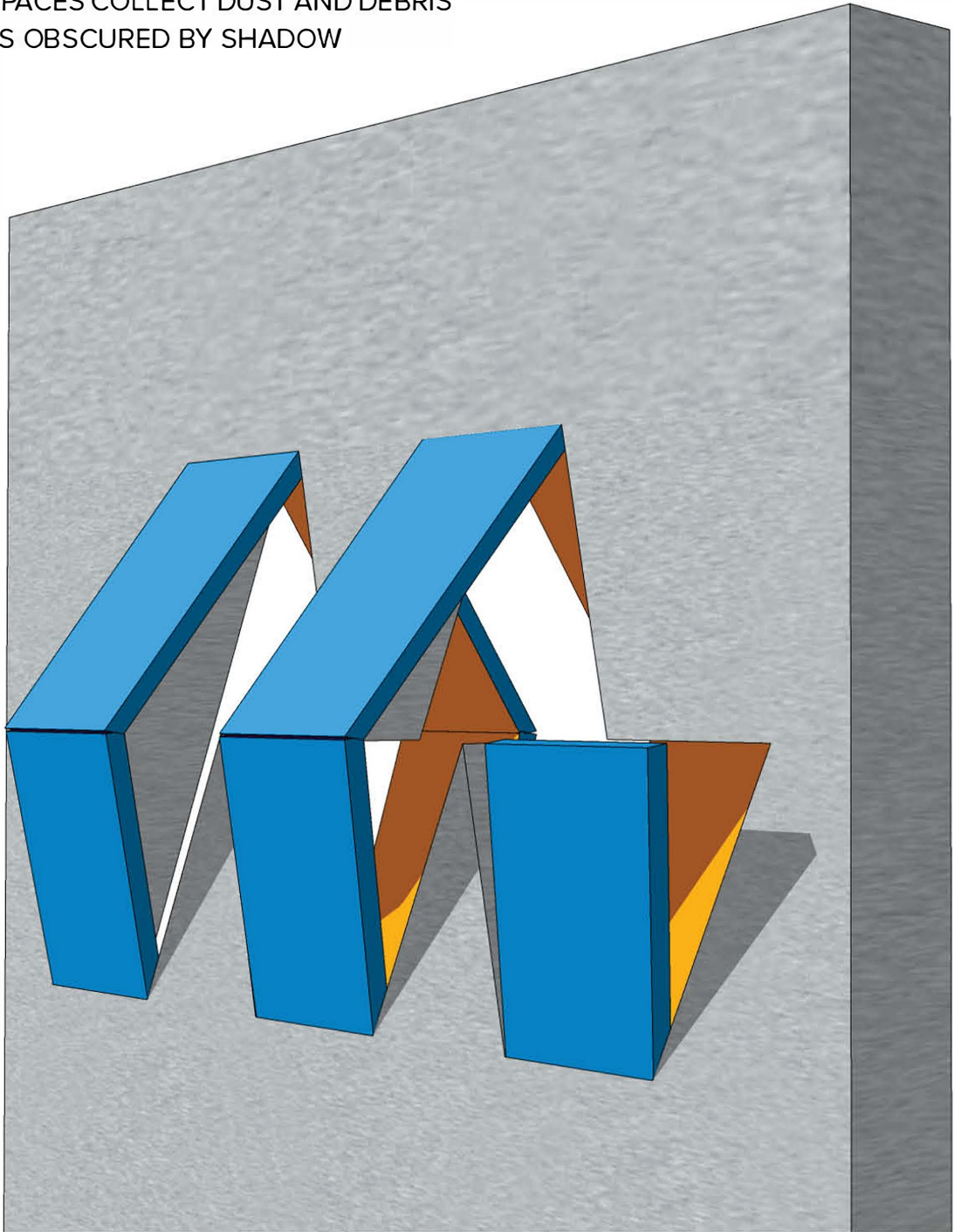

RECOMMENDED  
DESIGN

- EASE OF MAINTENANCE & FABRICATION
- AVOIDS DUST COLLECTION
- CLEAR REPRESENTATION OF LOGO

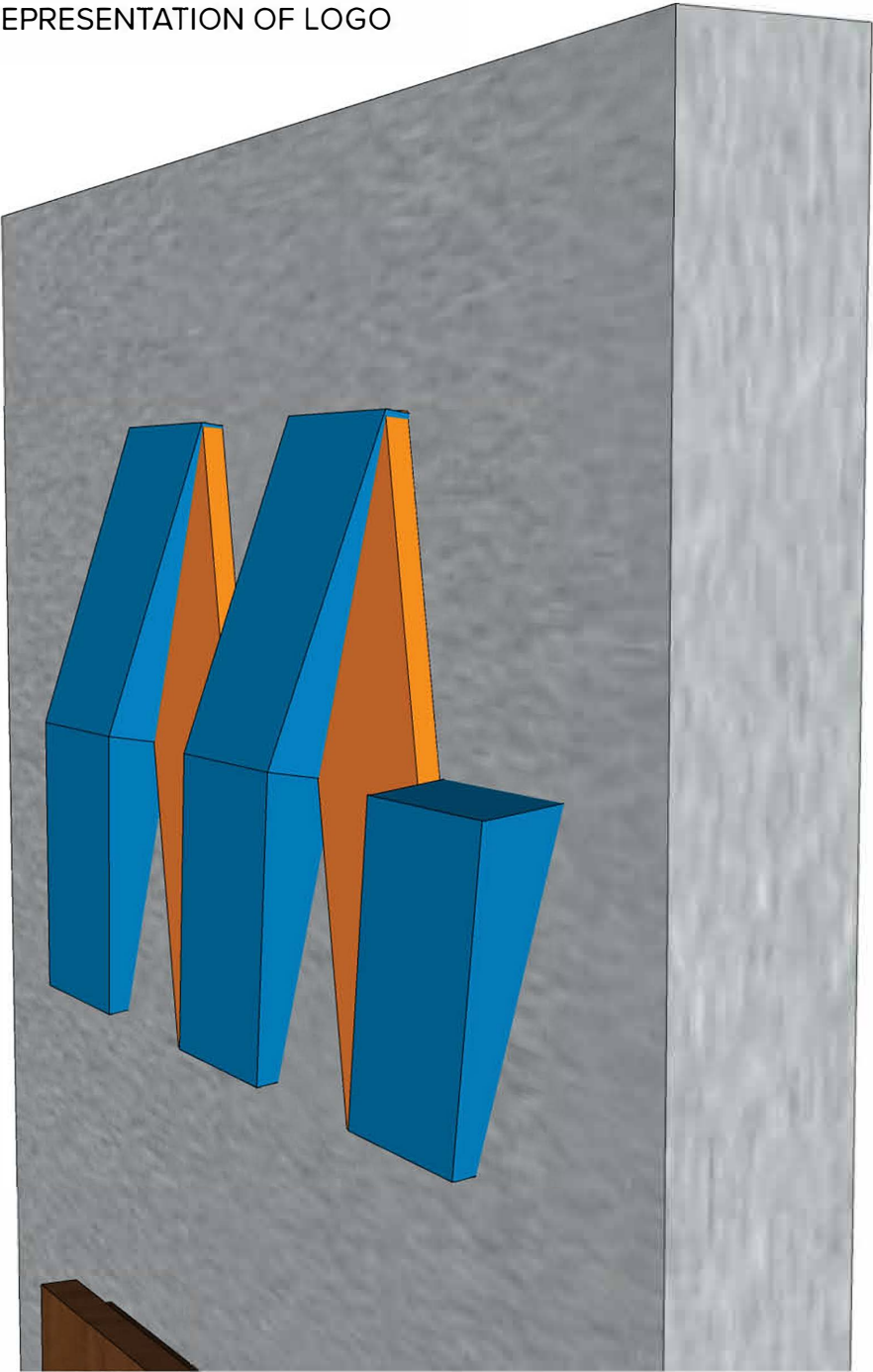

rsmdesign

San Clemente, CA  
949.492.9479

Dallas, TX  
972.974.3690

Los Angeles, CA  
213.705.9006

rsmdesign.com

PACKAGE NOTES

All drawings and written materials appearing herein constitute original and unpublished work of RSM Design Inc. and may not be used or disclosed without written consent of RSM Design Inc.

All drawings must comply with specifications noted in this document.

PLEASE NOTE

All reference images are for internal use only. RSM Design does not have copyrights for said images and therefore should not be published or shared.

REVISIONS:      DATE:

1	1
2	2
3	3
4	4
5	5



1 Top View  
Scale : 3/4"=1'

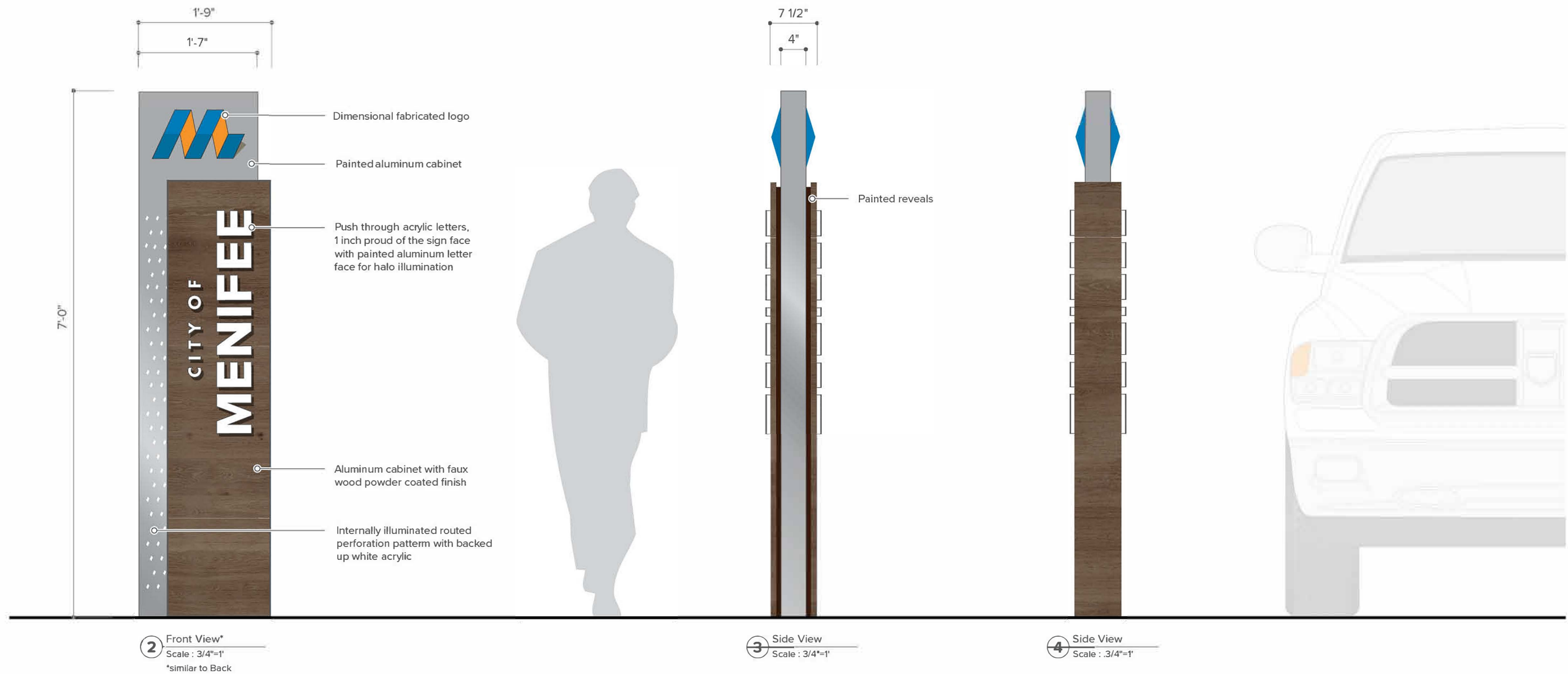

**PACKAGE NOTES**  
All drawings and written materials appearing herein constitute original and unpublished work of RSM Design Inc. and may not be used or disclosed without written consent of RSM Design Inc.

All drawings must comply with specifications noted in this document.

**PLEASE NOTE**  
All reference images are for internal use only. RSM Design does not have copyrights for said images and therefore should not be published or shared.

REVISIONS:	DATE:
1	
2	
3	
4	
5	
6	
7	
8	
9	
10	



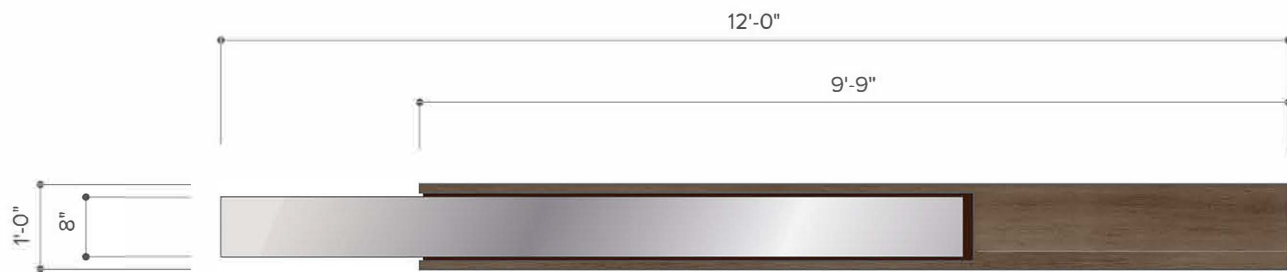

1 Top View  
Scale : 1/2"=1'



Existing Conditions

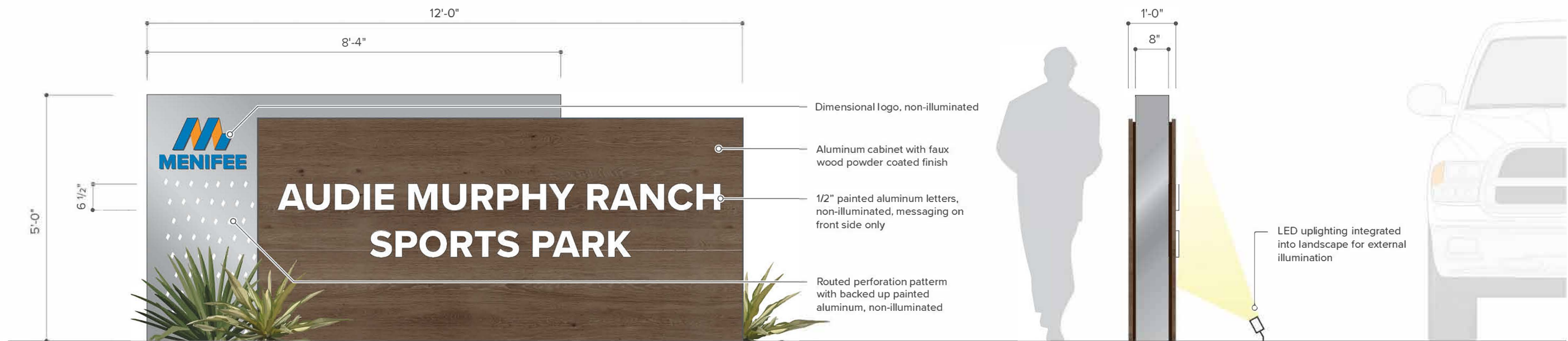

2 Front & Back View  
Scale : 1/2"=1'

3 Side View  
Scale : 1/2"=1'

SCHEMATIC DESIGN ONLY AND NOT INTENDED FOR FINAL PRICING OR FABRICATION.  
ALL DESIGNS SHOWN ARE COPYRIGHT OF RSM DESIGN & CAN NOT BE USED FOR THE PRODUCTION OF SHOP DRAWINGS WITHOUT WRITTEN CONSENT FROM RSM DESIGN.

D1 | Park Identification  
Notes and Details

CITY OF  
**MENIFEE**

rsmdesign

San Clemente, CA  
949.492.9479

Dallas, TX  
972.974.3690

Los Angeles, CA  
213.705.9006

rsmdesign.com

PACKAGE NOTES  
All drawings and written materials appearing herein constitute original and unpublished work of RSM Design Inc. and may not be used or disclosed without written consent of RSM Design Inc.

All drawings must comply with specifications noted in this document.

PLEASE NOTE  
All reference images are for internal use only. RSM Design does not have copyrights for said images and therefore should not be published or shared.

REVISIONS:      DATE:

1		1
2		2
3		3
4		4
5		5

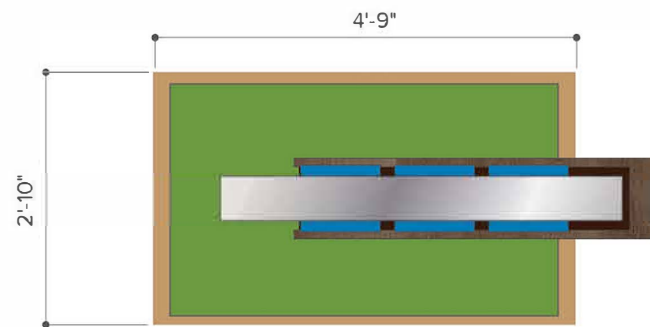

**1** Top View  
Scale : 1/2"=1'

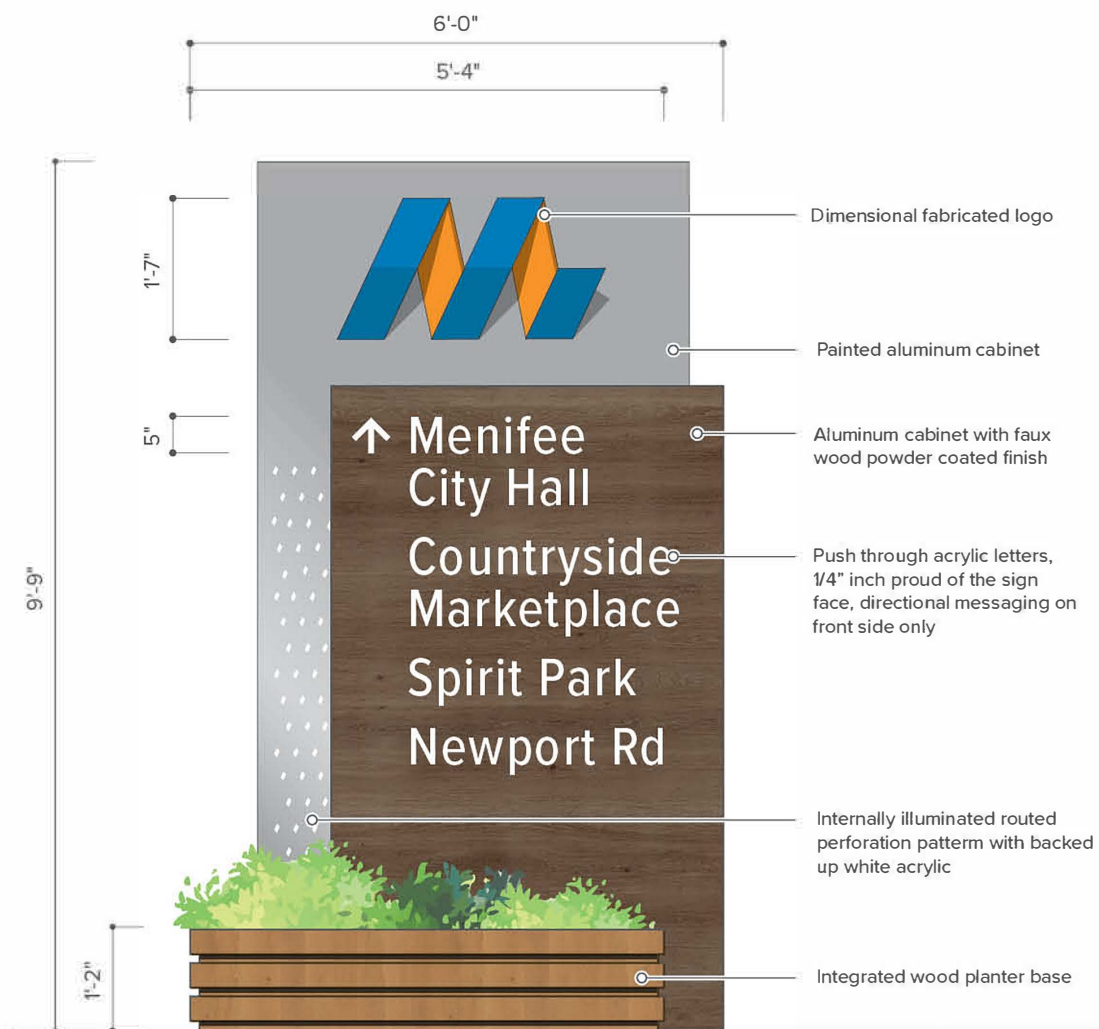

**2** Front View\*  
Scale : 1/2"=1'  
\*similar to Back

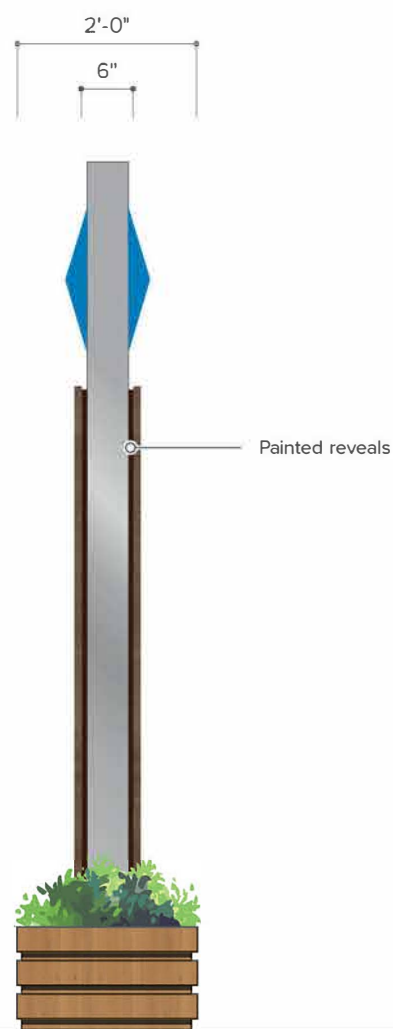

**3** Side View  
Scale : 1/2"=1'



**4** Side View  
Scale : 1/2"=1'



**PACKAGE NOTES**  
All drawings and written materials appearing herein constitute original and unpublished work of RSM Design Inc. and may not be used or disclosed without written consent of RSM Design Inc.

All drawings must comply with specifications noted in this document.

**PLEASE NOTE**  
All reference images are for internal use only. RSM Design does not have copyrights for said images and therefore should not be published or shared.

REVISIONS:      DATE:

1		1	
2		2	
3		3	
4		4	



Placemaking Signage

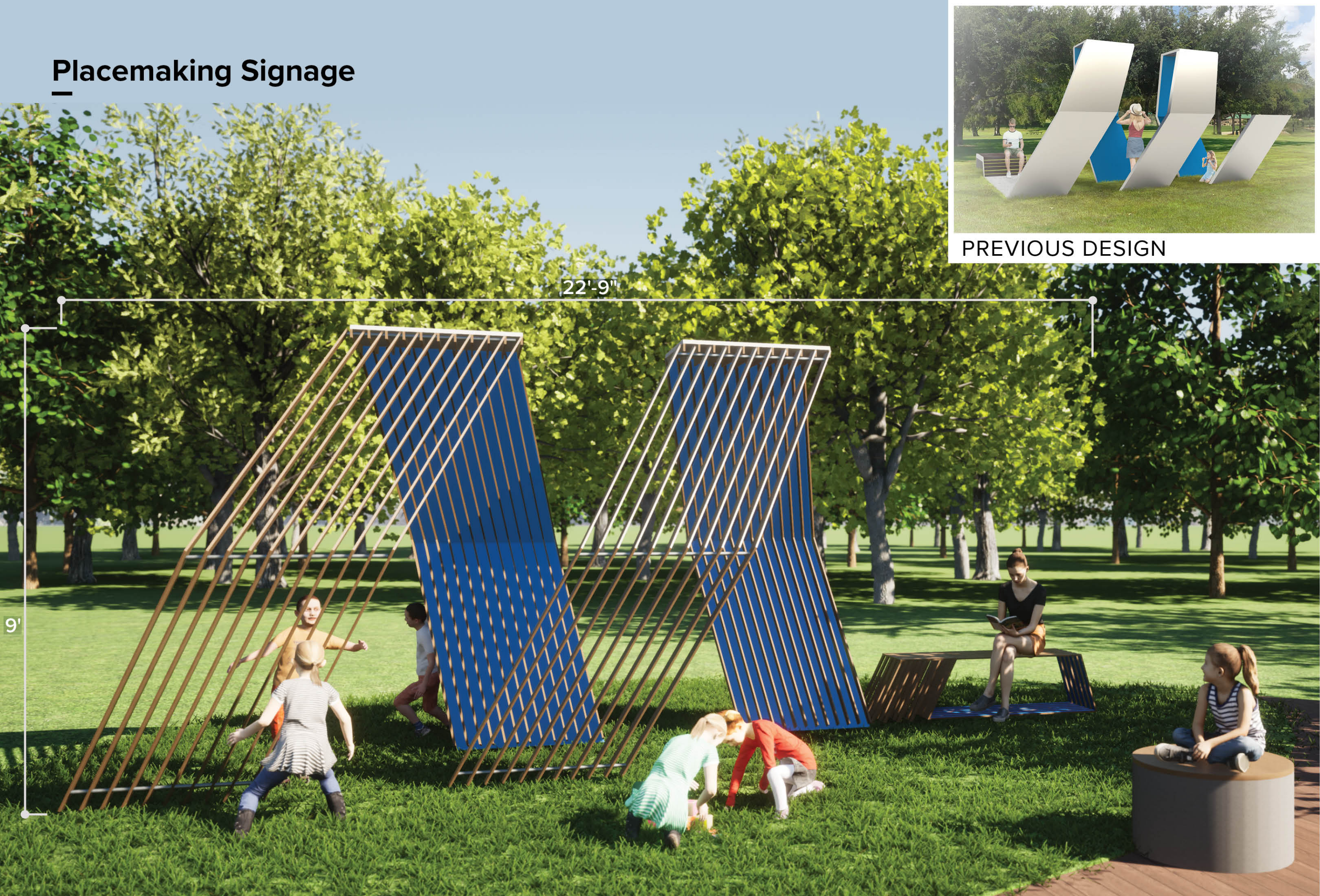

PREVIOUS DESIGN



**Concept One**

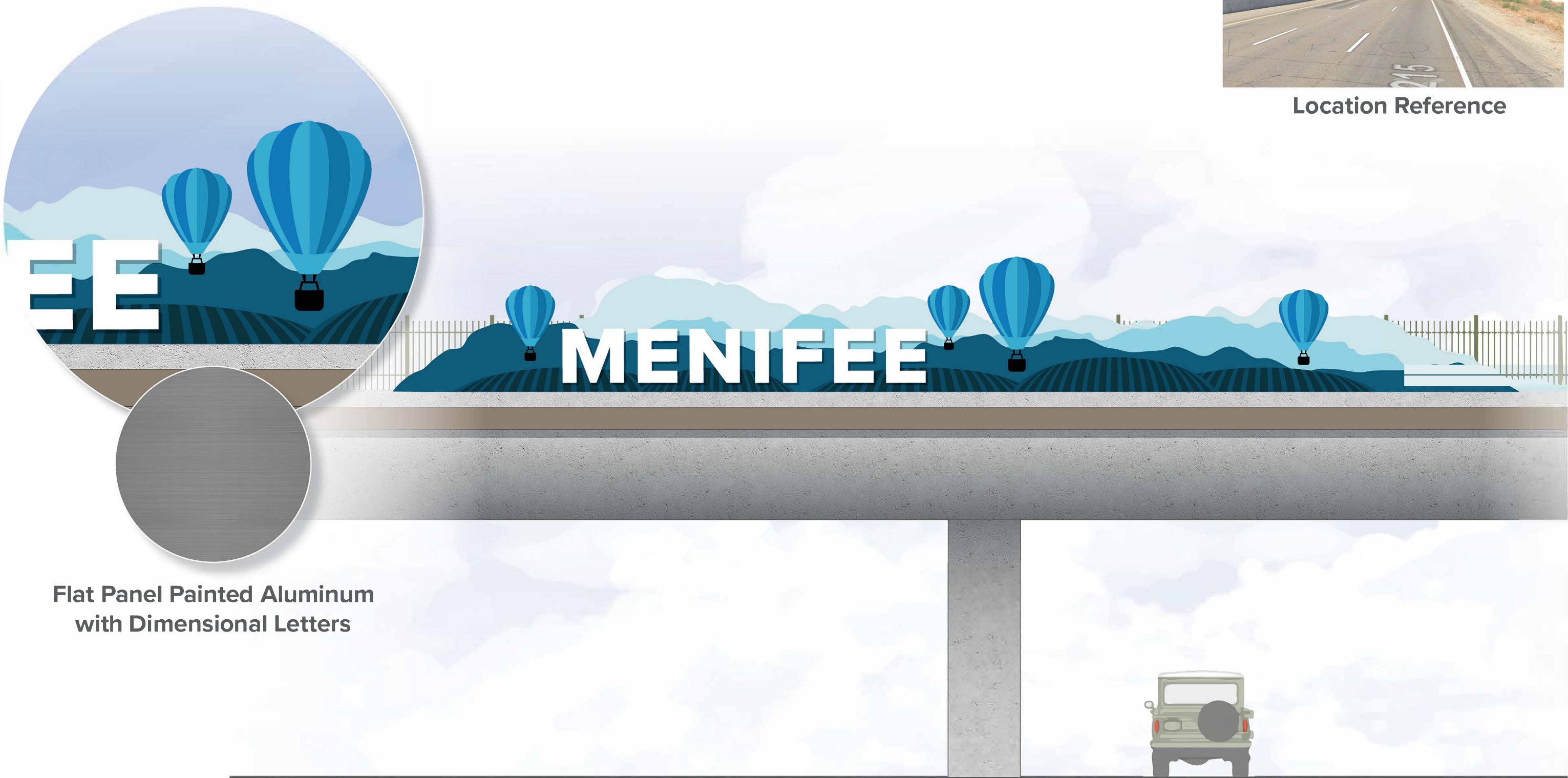

**Flat Panel Painted Aluminum  
with Dimensional Letters**



**Location Reference**





OPTION A: Black on White (Preferred)



OPTION B: White on Blue (PMS 294)

11/15/2024 1:10:00 PM

1 Front View  
Scale : 3"=1'



Existing Conditions: White on Brown

CITY OF  
**MENIFEE**

**rsm**design

San Clemente, CA  
949.492.9479

Dallas, TX  
972.974.3690

Los Angeles, CA  
213.705.9006

[rsmdesign.com](http://rsmdesign.com)

PACKAGE NOTES  
All drawings and written materials appearing herein constitute original and unpublished work of RSM Design Inc. and may not be used or disclosed without written consent of RSM Design Inc.

All drawings must comply with specifications noted in this document.

PLEASE NOTE  
All reference images are for internal use only. RSM Design does not have copyrights for said images and therefore should not be published or shared.

REVISIONS:	DATE:





Existing Conditions



Reference Image

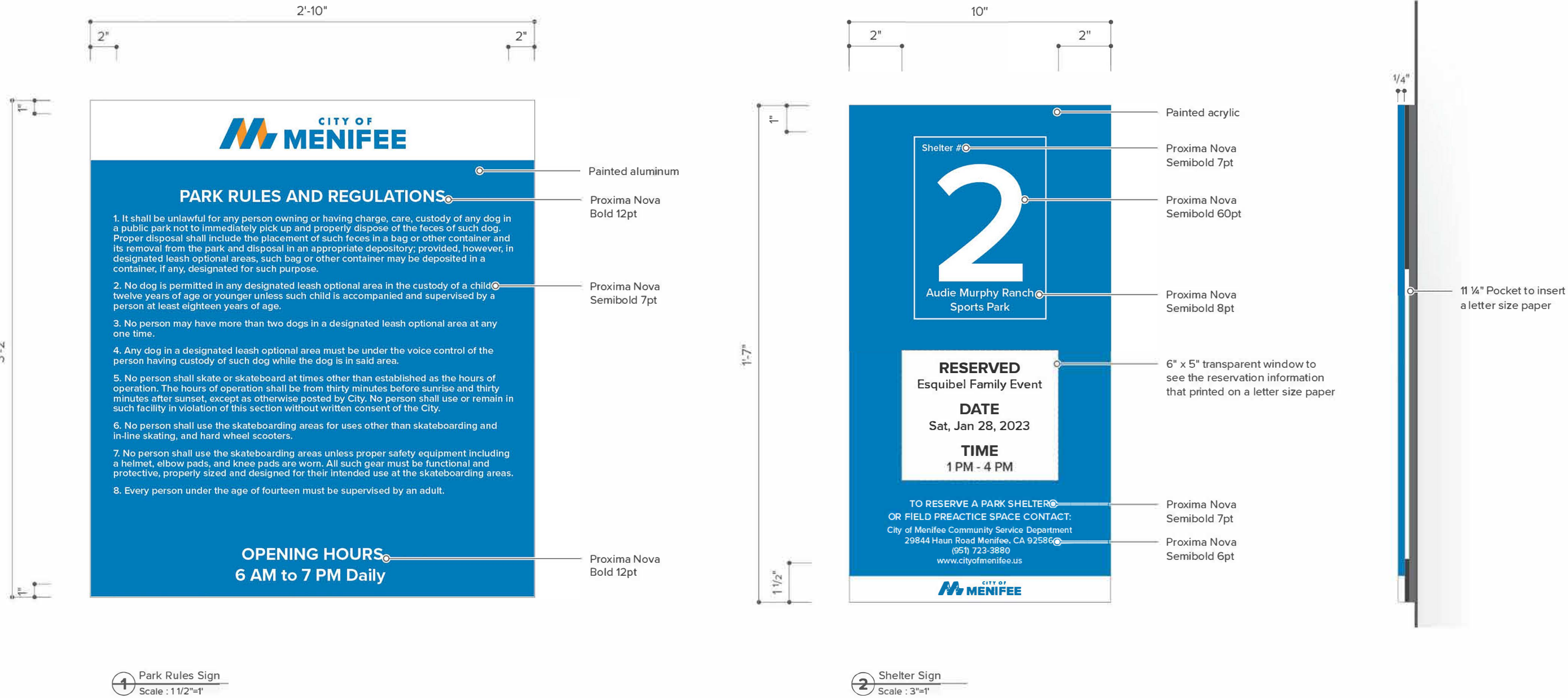

## rsmdesign

San Clemente, CA  
949.492.9479

Dallas, TX  
972.974.3690

Los Angeles, CA  
213.705.9006

rsmdesign.com

### PACKAGE NOTES

All drawings and written materials appearing herein constitute original and unpublished work of RSM Design Inc. and may not be used or disclosed without written consent of RSM Design Inc.

All drawings must comply with specifications noted in this document.

### PLEASE NOTE

All reference images are for internal use only. RSM Design does not have copyrights for said images and therefore should not be published or shared.

REVISIONS:      DATE:



rsmdesign

San Clemente, CA  
949.492.9479

Dallas, TX  
972.974.3690

Los Angeles, CA  
213.705.9006

rsmdesign.com

**PACKAGE NOTES**  
All drawings and written materials appearing herein constitute original and unpublished work of RSM Design Inc. and may not be used or disclosed without written consent of RSM Design Inc.

All drawings must comply with specifications noted in this document.

**PLEASE NOTE**  
All reference images are for internal use only. RSM Design does not have copyrights for said images and therefore should not be published or shared.

REVISIONS:      DATE:

1	
2	
3	
4	
5	
6	
7	
8	
9	
10	

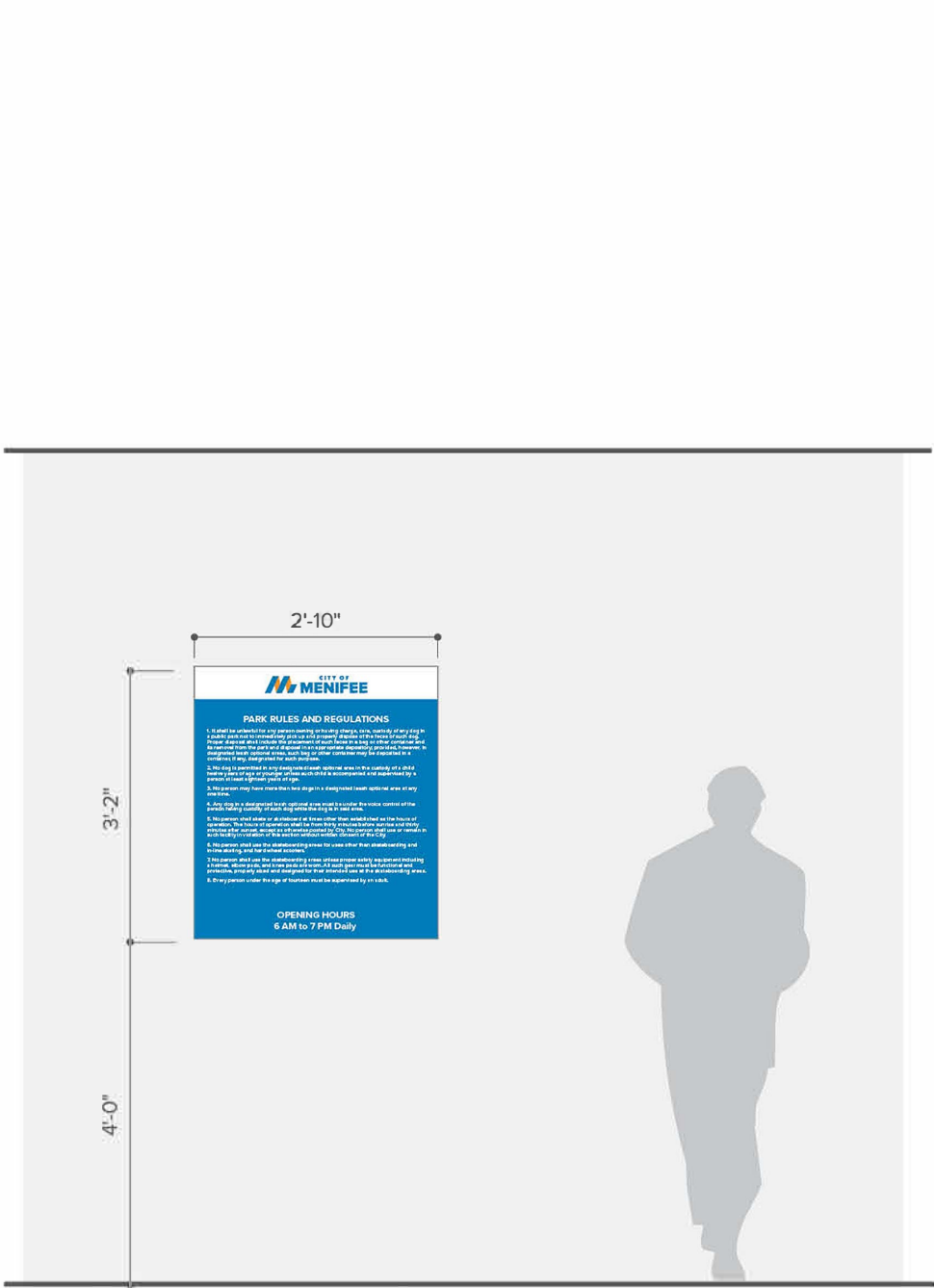

**1** Wall Mounted  
Scale : 1/2"=1'

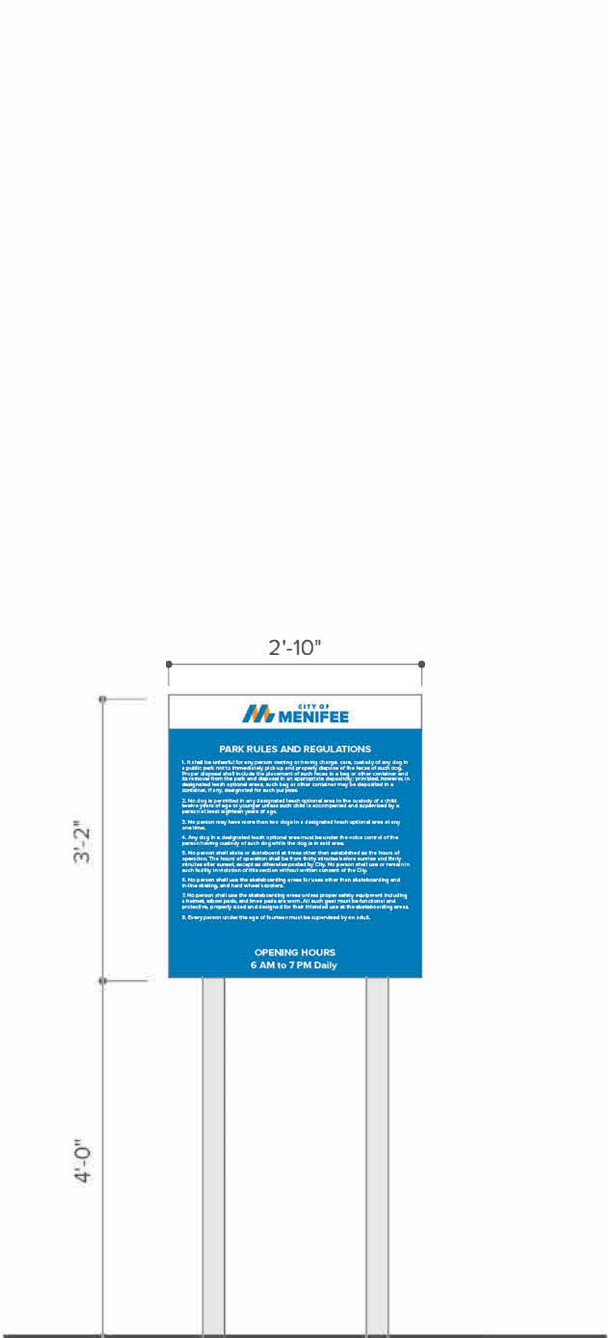

**2** Freestand  
Scale : 1/2"=1'



**3** Pole Mounted  
Scale : 3/8"=1'



Sign Locations

Overall Site Plan

The sign locations for the City of Menifee have been broken into four quadrants to allow better visibility of each sign location.

#	PROJECT SIGNAGE
B.1	Primary Gateway
C.1	Monument Signage
D.1	Park Identification Signage*
E.1	Vehicular Directional Signage
G.1	Overpass Signage
H.1	Placemaking Signage*
J.1	Street Sign (Prototypical)*
K.1	Informational Signage (Prototypical)*
M.1	Regulatory Signage (Prototypical)*

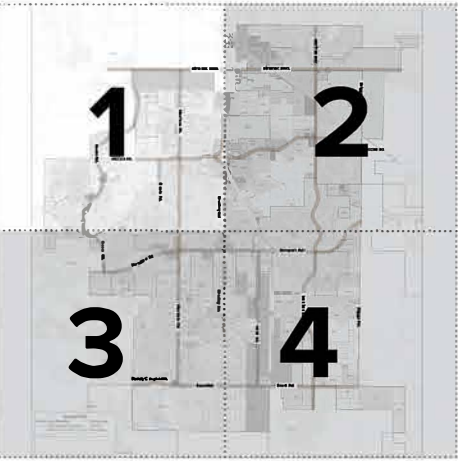
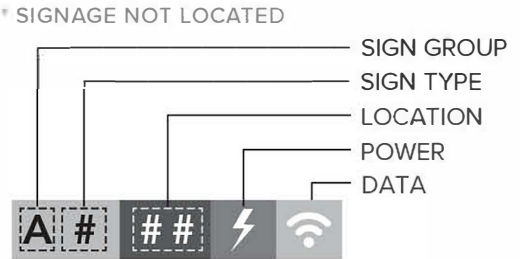

Revision Table		
Revision Date	Description	Ordinance No.
3/9/2019	Update: accepted by City Council	Ord. No. 2017-
3/19/2020	CP Land Use Amendment: PLAN 19-0016	Ord. No. 2019-285

\*The locations are conceptual only, final locations of each sign will be subject to review/approval by the City Engineer and/or Community Development Director.

CITY OF

MENIFEE

rsmdesign

San Clemente, CA  
949.492.9479

Dallas, TX  
972.974.3690

Los Angeles, CA  
213.705.9006

rsmdesign.com

PACKAGE NOTES

All drawings and written materials appearing herein constitute original and unpublished work of RSM Design Inc. and may not be used or disclosed without written consent of RSM Design Inc.

All drawings must comply with specifications noted in this document.

PLEASE NOTE

All reference images are for internal use only. RSM Design does not have copyrights for said images and therefore should not be published or shared.

REVISIONS:

DATE:



# THANK YOU

## PLEASE NOTE

All drawings and written materials appearing herein constitute original and unpublished work of RSM Design Inc. and may not be used or disclosed without written consent of RSM Design Inc.

Some reference images used within this document are for internal use only.

RSM Design does not have the copyrights for the various images used and therefore are not to be published or shared.

TAILORED AND CRAFTED BY

**rsm**design